

Catalogue  
**2020**



Download your copy!

**MUJI**  
無印良品





Select product codes & call or contact us on  
**WhatsApp for business: +9651821212**  
**WhatsApp direct: +96597264813**



**Home Delivery** - Processed and shipped between **2 to 6 business days**  
Excluding Fridays & public holidays.

Delivery cost is KD 3 or **Free delivery** on orders **KD 8 and above.**

## What is MUJI?

### “NO LABEL. QUALITY GOODS”

MUJI is derived from its Japanese name ‘Mujirushi Ryohin’ which means ‘no label quality goods’. The brand launched in Japan in the 1980s with its no label, value-led, less is more concept.

MUJI is a renowned producer of stylish, functional and affordable quality goods that are relevant to all aspects of urban living, whether at work, rest or play.

Today MUJI has more than 800 stores worldwide and offers various consumer related products, including; household goods, stationery, travel accessories, beauty products and fashion.

In the Middle East, MUJI has stores in Kuwait, UAE, KSA, Bahrain, Qatar and Oman.



# MUJI Philosophy & Values

## Philosophy

- 1. Selection of materials:**  
We use many recycled materials, with an emphasis on quality. This enables us to create low-priced, high-quality products.
- 2. Streamlining processes:**  
Processes that have no bearing on a product's quality such as sorting, sizing, and polishing are eliminated. Focusing on true quality, MUJI's processes eliminate waste and reduce costs.
- 3. Simplification of packaging:**  
MUJI seeks to highlight products' natural colors and shapes. MUJI products appear in simple packaging bearing only product related information and a price tag.

## Values

- 1.** MUJI is not a brand whose value rests in the frills and "extras"
- 2.** MUJI is simplicity – but a simplicity achieved through a complexity of thought and design
- 3.** MUJI's streamlining is the result of careful elimination of gratuitous features and design unrelated to function
- 4.** MUJI, the brand, is rational, and free of agenda, doctrine, and "isms"
- 5.** MUJI aspires to modesty and plainness, to appeal to a wide group of people



# BEST SELLERS!

## ★ Aroma Diffuser



### Ultrasonic Aroma Diffuser

4547315880621 / Small -

29.00 KD, 315.00 SAR/AED, 299.00 QR, 35.00 BD/OMR

The ultrasonic waves spread the aroma to enjoy together with the lights. The white cylinder houses a lamp that shines with an ambient glow and has 2 light settings.

### Ultrasonic Aroma Diffuser

4549738380283 / Large -

39.00 KD, 415.00 SAR/AED, 399.00 QR, 45.00 BD/OMR

Plenty of mist with pleasure of aroma even in a large room. 3-2 drops of essential oils for 100ml of water

## ★ Essential Oils

### Herb & Flower

Herb aroma is recommended for relaxing.



### ★ Lemongrass

4550002546663 30 ml

11.00 KD, 130.00 AED/SAR/QR, 13.00 BD/OMR

Its sharp refreshing scent produces a cooling sensation. It is known that insects show aversion to the smell.



### ★ Lavender

4550002546625 30 ml

11.00 KD, 130.00 AED/SAR/QR, 13.00 BD/OMR

Its woody based gentle floral scent eases tension and has calming effect.

## ★ Gusset Case Collection

This cloth gusset case can be used to store and organise bulky clothes when travelling. It can be folded into a pocket size so as to save space.

L-4550002868956 | 40 x 53 x 10 cm

6.50 KD, 80.00 SAR/AED, 80.00 QR, 7.75 BD/OMR



## ★ Floor Chair

This simple floor chair matches any kind of room.

A legless chair with covering. With 6-step reclining function.

4548718481286 | L, W 57 x D 102 x H 10 cm,

21.00 KD, 300.00 SAR/AED/QR, 27.00 BD/OMR



### Cotton Canvas Cover For Floor Chair

12.00 KD, 100.00 SAR/AED, 75.00 QR, 14.00 BD/OMR

4549337746886 - Ecru



4547315999699 - Dark Brown



4547315999057 - Beige



## ★ Down Blend Pillow

4549738994428 | 50 x 70 cm

30.00KD ,420.00 AED/SAR , 400.00 QR, 35 BD/OMR



## ★ Acrylic Stand For Glasses

4934761174280 | 16.00 KD, 185.00 SAR/AED, 175 QR, 19 BD/OMR

Approx. W 6.7 x D 17.5 x H 25 cm



## ★ Pp Storage Case Drawer / Wide Deep

4548718182800 14.00 KD, 170.00 SAR/AED, 160.00 QR, 17.00 BD/OMR

Approx. W 55 x D 44.5 x H 30 cm



## ★ Acrylic Stand For Glasses

4549738970125 | 16.00 KD, 195.00 SAR/AED, 185.00 QR, 19.00 BD/OMR

Approx. W 25.5 x D 17 x H 9.5 cm



## ★ Acrylic Box 2 Drawer / L

4549738300397 | 16.00 KD, 195.00 SAR/AED, 185.00 QR, 19.00 BD/OMR

Approx. W 25.5 x D 17 x H 9.5 cm



## ★ Velour Partition

Velour Partition 3 x 5 / Grey

4549738373544 | 6.00 KD, 70.00

SAR/AED/QR, 8.00 BD/OMR

Approx. W 15.5 x D 12 x H 2.5 cm

Velour With Ring Partition / L / Grey

4549738373551 | 6.00 KD, 90.00 SAR/AED,

85.00 QR, 7.00 BD/OMR

Approx. W 23.5 x D 15.5 x H 2.5 cm



## ★ PP Storage Case Drawer / Wide / L

4945247266740 | 12.50 KD, 145.00 SAR/AED, 135.00 QR, 16.00 BD/OMR

Approx. W 55 x D 44.5 x H 24 cm



## ★ PP Storage Case Drawer / Wide / M / 4 Row

4548718510269 | 30.00 KD, 370.00 SAR/AED, 350.00 QR, 40.00 BD/OMR

Approx. W 55 x D 44.5 x H 90 cm



# Health & Beauty



Essential Oils 81



Aroma Diffuser 85



Skin Care 87



Nail care 90



Pet bottles 91



Cosmetic Tools 93



Cut Cotton & Cotton Buds 95



Nylon Makeup Boxes 97

## Essential oils

MUJI Essential Oils are pure and natural, from flowers and fruits harvested in areas they are famous for, such as Lavender from Provence, and Lemon or Blood Orange from Sicily Islands in Italy.

### What are essential oils?

Essential oils are the volatile molecules of a plant that most commonly provide it with fragrance, flavour and often therapeutic or aroma-therapeutic properties. They are extracted either through steam distillation of the leaves, wood and/or flowers, or cold expressed from the rind or peel.

The amount of oil extracted varies from plant to plant depending on the number of oil glands and method of extraction. For instance, it will take between 18 - 16 oranges to produce 10ml of essential oil; however, approximately 100kg of rose flowers will make 10ml of essential oil.



## Herb & Flower

Herb aroma is recommended for relaxing.

10 ml - 5.00 KD, 60.00 AED/SAR/QR, 6.00 BD/OMR

30 ml - 11.00 KD, 130.00 AED/SAR/QR, 13.00 BD/OMR



### Lavender

4550002546618	10 ml
4550002546625	30 ml

Its woody based gentle floral scent eases tension and has calming effect.



### Geranium

4550002546670	10 ml
4550002546687	30 ml

It gives out a sweet and deep aroma similar to a rose. It stabilises the mind and brightens the mood. It is known that insects show aversion to the smell.



### Lemongrass

4550002546656	10 ml
4550002546663	30 ml

Its sharp refreshing scent produces a cooling sensation. It is known that insects show aversion to the smell.



### Rosemary

4550002546632	10 ml
4550002546649	30 ml

Its clear and cool scent is refreshing and energizes the body. It has been used as an insect repellent or to remove the smell of meat since ancient times.

## Citrus

The citrus aroma is recommended for energising.

10 ml - 5.00 KD, 60.00 AED/SAR/QR, 6.00 BD/OMR

30 ml - 11.00 KD, 130.00 AED/SAR/QR, 13.00 BD/OMR



### Sweet Orange

4550002546731	10 ml
4550002546748	30 ml

This is characterised by the sweet and fresh scent representing the citrus group. It is said to brighten and calm the mind.



### Grapefruit

4550002546779	10 ml
4550002546786	30 ml

It gives out a familiar refreshing scent with subtle bitterness to it. It lifts the mood and boosts the spirits.



### Lemon

4550002546816	10 ml
4550002546823	30 ml

Its crisp, tart citrus scent refreshes and brightens the mood.



### Bergamot

4550002546793	10 ml
4550002546809	30 ml

Of all the citrus fragrance group, this gives out the sweetest, warmest citrus scent with floral note. It brightens and calms the mind.



### Lime

4550002546854	10 ml
4550002546861	30 ml

Lime has a tart and bitter citrus aroma. It has a delightfully refreshing scent that brightens the mood.

## Mint & Wood

The Mint and Wood aroma is recommended for the time for refreshing.

10 ml - 5.00 KD, 60.00 AED/SAR/QR, 6.00 BD/OMR

30 ml - 11.00 KD, 130.00 AED/SAR/QR, 13.00 BD/OMR



### Eucalyptus

4550002546519	10 ml
4550002546526	30 ml

Its minty sharp scent brightens the mood and helps you stay focused.



### Tea Tree

4550002546533	10 ml
4550002546540	30 ml

Its clear and clean scent, like medicine brightens a dull mood, producing a refreshing feeling. It comes in handy during the pollen seasons in spring and autumn.



### Peppermint

4550002546557	10 ml
4550002546564	30 ml

Its refreshing menthol scent helps you stay focused.



### Japanese Cypress

4550002546878	10 ml
4550002546885	30 ml

This woody scent is familiar to Japanese people. Its crisp and nostalgic scent makes the mind calm and relaxed period

## Blending Essential Oils

**Step 1:**  
Select an essential oil according to the benefit you would like to produce. Smell the oil, and if you like it then put it to one side.

**Step 2:**  
Look at the benefits related to the oils and select an oil that produces the benefit you are looking for.

**Step 3:**  
Hold the two selected oils in one hand and waft the scent towards your nose, if you like the general scent continue to Step 5, alternatively return to step 2 and select a different essential oil.

### Blending based on aroma

**Step 1:**  
Select an essential oil based on the aroma, i.e. smell the different oils and select the one you like.

**Step 2:**  
Select an oil and hold it in one hand alongside your original and waft the scent towards your nose, if you like the general odour continue to step 3.

**Step 4:**  
Once you have selected your oils, smell each individually and compare strengths. If one is a lot stronger than the other, use less drops. If they are both equally strong, use equal amounts. (Note: this is also subjective, you may prefer the fragrance of one oil over the other and decide that you would like to increase the strength of that oil by using more drops).

**Step 5:**  
Apply the blend according to the usage chart.

**Step 3:**  
Once you have selected your oils, smell each individually and compare strengths. If one is a lot stronger than the other use less drops. If they are both equally strong, use equal amounts. (Note: this is also subjective, you may prefer the fragrance of one oil over the other and decide that you would like to increase the strength of that oil by using more drops)



	Bergamot	Eucalyptus	Grapefruit	Lavender	Lemon	Lemongrass	Orange	Yang Yang
Bergamot	•	•	•	•	•		•	•
Eucalyptus	•			•	•			
Grapefruit	•			•	•		•	•
Lavender	•	•	•		•	•		
Lemon	•	•	•				•	•
Lemongrass		•		•				•
Orange	•		•	•	•			
Yang Yang	•		•	•	•			

### Essential oil blending compatibility chart

Relaxing & Calming
Refreshing & Invigorating
Strengthening & Reviving

## Aroma Stone with Plate

Apply your desired fragrance, like fragrance oil and essential oil, on aroma stone to enjoy the fragrance.

3.25 KD, 40.00 AED/SAR/QR, 4.25 BD/OMR



Aroma Stone

4550002868291 / Gray



Aroma Stone

4550002868284 / White





## Aroma Diffuser

The Ultrasonic Aroma Diffuser is great to enjoy the original aroma of essential oil because it changes water and essential oil into the mist foam to spread around the rooms without adding the heat.



### Ultrasonic Aroma Diffuser

4547315880621 / **Small.**

The ultrasonic waves spread the aroma to enjoy together with the lights.

The white cylinder houses a lamp that shines with an ambient glow and has 2 light settings.

29.00 KD, 315.00 SAR/AED, 299.00 QR, 35.00 BD/OMR



### Ultrasonic Aroma Diffuser

4549738380283 / **Large**

Plenty of mist with pleasure of aroma even in a large room. 3-2 drops of essential oils for 100ml of water

39.00 KD, 415.00 SAR/AED, 399.00 QR, 45.00 BD/OMR

#### Operation:

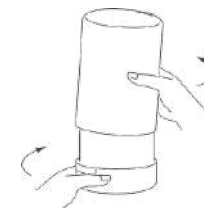

1. Twist anticlockwise to open the cover

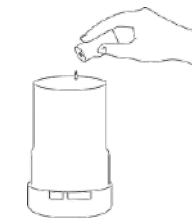

2. Pour the required amount of water into the tank, using the measuring cup provided. 3-2 drops of essential oils should be added for 100ml of water.

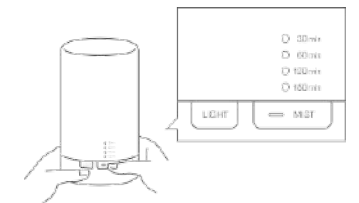

3. Plug in the adapter to the power supply and switch on.



### Portable Aroma Diffuser

4550002494063 17.00 KD, 200.00 SAR/AED/QR, 17.00 BD/OMR



The portable diffuser can be charged by USB. Its rechargeable battery can be charged via a laptop with a USB cable, and lasts up to eight hours.



Muji fitted it with a small fan so that it needs just a few drops of oils, rather than water.



The Portable Aroma Diffuser comes with a black cushioned case accompanied with pockets inside to hold a charging cable and a 10-millilitre essential oil bottle.

## Skincare

**MUJI's Sensitive Skincare Series is derived from natural waters of Kamaishi caves in the Iwate Prefecture.**

The silky natural water pumped out from the cave is extremely soft, with almost the same pH level as human tears, hence it's able to soak rapidly into the skin.

Irritation on the skin is caused by many factors such as environment, stress and tiredness, so MUJI considers the importance of skincare that is gentle on the skin.

MUJI's sensitive skincare range is hypoallergenic, fragrance-free, Paraben free and Alcohol free, with no added colours or mineral oils. All skincare ranges contain natural flower and fruit extracts. This makes the skincare range suitable for everyone.



## Cleansing



### Oil Cleansing

4548076448860	200 ml - <b>6.00 KD, 70.00 SAR/AED/QR, 8.00 BD/OMR</b>
4548076448877	50 ml - <b>2.50 KD, 30.00 SAR/AED/QR, 3.50 BD/OMR</b>

This cleanser contains plant-derived cleansing ingredients to protect sensitive skin. The oil ingredients, primarily olive oil, are 100% botanical.

## Toning:



### Light Toning Water • Light

4548076444947	200 ml - <b>4.25 KD, 50.00 SAR/AED/QR, 6.00 BD/OMR</b>
4548076446026	50 ml - <b>1.25 KD, 15.00 SAR/AED/QR, 1.75 BD/OMR</b>



### Light Toning Water • Moisture

4548076444954	200 ml - <b>4.25 KD, 50.00 SAR/AED/QR, 6.00 BD/OMR</b>
4548076446071	50 ml - <b>1.25 KD, 15.00 SAR/AED/QR, 1.75 BD/OMR</b>



### Light Toning Water • High Moisture

4548076444961	200 ml - <b>4.25 KD, 50.00 SAR/AED/QR, 6.00 BD/OMR</b>
4548076446156	50 ml - <b>1.25 KD, 15.00 SAR/AED/QR, 1.75 BD/OMR</b>

Hypoallergenic toner protects delicate skin against dryness.

## Moisturising



### Moisturising Milk • Light

4548076448358	200 ml - <b>4.25 KD, 50.00 SAR/AED/QR, 6.00 BD/OMR</b>
4548076448389	50 ml - <b>1.25 KD, 15.00 SAR/AED/QR, 1.75 BD/OMR</b>



### Moisturising Milk • Moisture

4548076448365	200 ml - <b>4.25 KD, 50.00 SAR/AED/QR, 6.00 BD/OMR</b>
4548076448396	50 ml - <b>1.25 KD, 15.00 SAR/AED/QR, 1.75 BD/OMR</b>



### Moisturising Milk • High Moisture

4548076448372	200 ml - <b>4.25 KD, 50.00 SAR/AED/QR, 6.00 BD/OMR</b>
4548076448402	50 ml - <b>1.25 KD, 15.00 SAR/AED/QR, 1.75 BD/OMR</b>

Use after toner for an extra boost of moisture that leaves dry skin hydrated and super soft.



### Moisturising Cream

4548076448693	50 g - <b>4.25 KD, 50.00 SAR/AED/QR, 6.00 BD/OMR</b>
---------------	------------------------------------------------------

use as your final skincare step to seal in the moisturising ingredients provided by toner and Moisturising Milk.

## Nail Care



### Nail Polish

4548076103240  
Made from soft urethane with shining and filing components that give your nails a shine.  
**0.90 KD, 10.00 SAR/AED/QR, 1.25 BD/OMR**



### Nail File - Soft / 2pcs

4548718555116  
It smoothens the surface of the nails by removing uneven areas.  
**1.25 KD, 20.00 SAR/AED/QR, 1.25 BD/OMR**



### Nail File - Hard / 2pcs

4548718555109  
It shapes length and shape of the nails without harming them.  
**1.25 KD, 20.00 SAR/AED, 15.00 QR, 1.50 BD/OMR**



### Stainless Steel Folding Nail File

4547315852543 / 12.3 cm  
**1.50 KD, 20.00 SAR/AED, 15.00 QR, 2.00 BD/OMR**



### Steel Nail Clipper

**S** - 4547315822706 **2.50 KD, 35.00 SAR/AED, 30.00 QR, 3.00 BD/OMR**  
**L** - 4547315822690 **4.50 KD, 55.00 SAR/AED, 50.00 QR, 5.5 BD/OMR**

It is featured with precision blade which gives clear cut. You can cut the nails nicely and easily.

The file grooves are curved by laser, even the tip of file can be used. It is best used for precise and detailed care on nails. How to use: First, shape the nail's length with the coarse side. Then, polish the nail with the finer side. \*There is a marking "\*" on the base of the file for coarse side.



### Nail Care Set

4548718555123 **1.25 KD, 20 SAR/AED, 15.00 QR, 1.50 BD/OMR**

Set containing nail polish and nail file. Compact size makes it easy to carry. Pink: hard nail file, grey: soft nail file, white: nail buffer. File nails to desired length and shape using the rough surface (dark pink) and finish with the fine surface (light pink). Do not use on the surface of the nails.

# Pet Bottles

## Foam Type:

"The 'foam type' pump turns liquid soap into foam, which allows you to reduce the amount you use by up to 75%. Mix liquid soap and water. These bottles are not suitable for alcohol, petrol or solvent based products of any kind, including perfumes & vinegar.



Foam Type / Clear	Foam Type / White	Foam Type / Typolyethylene
250 ml- 4945247506754 – 1.75 KD, 25.00 SAR/AED/QR, 2.25 BD/OMR	250 ml- 4945247506778 – 1.75 KD, 25.00 SAR/AED/QR, 2.25 BD/OMR	50 ml- 4945247506846 – 1.25 KD, 20 SAR/AED/QR, 1.75 BD/OMR
400 ml- 4945247506761 – 2.00 KD, 30.00 SAR/AED/QR, 2.50 BD/OMR	400 ml- 4945247506785 – 2.00 KD, 30.00 SAR/AED/QR, 2.50 BD/OMR	

## Pump Type:

Square-shaped plastic bottles make use of all available space in narrow bathrooms and sink areas. Bottles that are convenient for refill of shampoo and conditioner. Tidy and organise your toiletries with these streamlined bottles made from PET. Not suitable for alcohol, petrol or solvent based products of any kind, including perfumes & vinegar.



Pump Type / Clear	Pump Type / White	Pump Type / Clear Gray
250 ml- 4547315853830 – 1.75 KD, 25.00 SAR/AED/QR, 2.25 BD/OMR	250 ml- 4548076712565 – 1.75 KD, 25.00 SAR/AED/QR, 2.50 BD/OMR	400 ml- 4550002868185 – 2.00 KD, 30.00 SAR/AED/QR, 2.50 BD/OMR
280 ml- 4547315853854 – 1.75 KD, 25.00 SAR/AED/QR, 2.25 BD/OMR	280 ml- 4548076712558 – 1.75 KD, 25.00 SAR/AED/QR, 2.50 BD/OMR	600 ml- 4550002868192 – 2.25 KD, 35.00 SAR/AED/QR, 3.00 BD/OMR
400 ml- 4550002867928 – 2.00 KD, 30.00 SAR/AED/QR, 2.50 BD/OMR	400 ml- 4550002867775 – 2.00 KD, 30.00 SAR/AED/QR, 2.50 BD/OMR	
600 ml- 4550002867935 – 2.25 KD, 35.00 SAR/AED/QR, 3.00 BD/OMR	600 ml- 4550002867782 – 2.25 KD, 35.00 SAR/AED/QR, 3.00 BD/OMR	

Pump Type / Gray
400 ml- 4550002868161 – 2.00 KD, 30.00 SAR/AED/QR, 2.50 BD/OMR
600 ml- 4550002868178 – 2.25 KD, 35.00 SAR/AED/QR, 3.00 BD/OMR



## Travel Bottles:

Due to security regulations at airports, MUJI developed a range of travel bottles that are all 100ml or smaller in size.

Available in screw top lids for lotions, spray tips for water based liquids, pump lids for moisturisers and creams, and flip caps ideal for liquid based substances such as shampoo.

These bottles are made from P.E.T. plastic and are not suitable for alcohol, petrol or solvent based products of any kind, including perfumes & vinegar.



Pet Bottle With Cap	Pet Pump Bottle	Pet Spray Bottle
30 ml- 4548718994212 - 0.50 KD, 5.00 SAR/AED/QR, 0.75 BD/OMR	15 ml- 4548718994236 – 0.90 KD, 10.00 SAR/AED/QR, 1.25 BD/OMR	12 ml- 4549337461475 – 1.00 KD/BD/OMR, 10.00 SAR/AED, 9.00 QR,
50 ml- 4548718994229 – 0.75 KD, 10.00 SAR/AED/QR, 1.00 BD/OMR	30 ml- 4548718994243 – 1.15 KD, 15.00 SAR/AED/QR, 1.50 BD/OMR	18 ml- 4549337461482 – 1.00 KD, 12.00 SAR/AED/QR, 1.35 BD/OMR
100 ml- 4548718994359 – 1.25 KD, 20.00 SAR/AED, 15.00 QR, 1.50 BD/OMR	50 ml- 4548718994250 – 1.25 KD, 20.00 SAR/AED/QR, 1.75	30 ml- 4548718994298 – 1.15 KD, 15.00 SAR/AED/QR, 1.50 BD/OMR
Bottle ideal for separating lotion, etc. Heat proof: 60 degrees Celsius , cold resistant: -20 degrees Celsius.	100 ml- 4548718994267 – 2.00 KD, 30.00 SAR/AED, 25.00 QR, 2.50 BD/OMR	50 ml- 4548718994304 – 1.25 KD, 20.00 SAR/AED/QR, 1.75 BD/OMR
	It is suitable for lotion division. Press several times until the content comes out. Heat resistance: 60 degrees Celsius Cold resistance: -20 degrees Celsius	100 ml- 4548718994311 – 2.00 KD, 30.00 SAR/AED, 25.00 QR, 2.50 BD/OMR
	Bottle ideal for separating lotion, etc. *Press several times until contents come out. Heat proof: 60 degrees Celsius , cold resistant: -20 degrees Celsius	

Polyethylene Bottle With Cap	Polyethylene Tube
12 ml- 4548718994151 – 0.35 KD, 3.00 SAR/AED/QR, 0.50 BD/OMR	30 g- 4550182202878 – 0.50 KD, 7.00 SAR/AED/QR, 0.75 BD/OMR
18 ml- 4548718994168 – 0.45 KD, 4.00 SAR/AED/QR, 0.65 BD/OMR	50 g- 4550182202885 – 1.00 KD/BD/OMR, 12.00 SAR/AED/QR
30 ml- 4548718994175 – 0.50 KD, 5.00 SAR/AED/QR, 0.75 BD/OMR	A squeezable bottle that's easy to use. Great for shampoo, conditioners, and liquids.
50 ml- 4548718994182 – 0.75 KD, 10.00 SAR/AED/QR, 1.00 BD/OMR	Heat resistance: 80 degrees Celsius Cold resistance: -20 degrees Celsius.
100 ml- 4548718994366 – 1.25 KD, 20.00 SAR/AED, 15.00 QR, 1.50 BD/OMR	
The bottle made of soft resin which is easy to squeeze out content. Heat resistance: 90 degrees Celsius Cold resistance: -20 degrees Celsius.	

## Cosmetic Tools

### Makeup Brushes:

The brushes are made of plant-derived polyester fiber.



- |                                                                                                                                                                                                                                                                                                                                                                                                                                                                                                                                                                                                                                                                                              |                                                                                                                                                                                                                                                                                                                                                                                                                 |                                                                                                                                                                                                                                                                                                                                                                                                                      |
|----------------------------------------------------------------------------------------------------------------------------------------------------------------------------------------------------------------------------------------------------------------------------------------------------------------------------------------------------------------------------------------------------------------------------------------------------------------------------------------------------------------------------------------------------------------------------------------------------------------------------------------------------------------------------------------------|-----------------------------------------------------------------------------------------------------------------------------------------------------------------------------------------------------------------------------------------------------------------------------------------------------------------------------------------------------------------------------------------------------------------|----------------------------------------------------------------------------------------------------------------------------------------------------------------------------------------------------------------------------------------------------------------------------------------------------------------------------------------------------------------------------------------------------------------------|
| <p><b>1-Cheek Brush</b><br/> <b>93 ml-</b> 4549337385887 –<br/> <b>6.50 KD, 80.00 SAR/AED, 75.00 QR, 8.50 BD/OMR</b><br/> <b>153 ml-</b> 4547315822799 –<br/> <b>7.50 KD, 90.00 SAR/AED, 85.00 QR, 9.00 BD/OMR</b><br/> <b>164 ml-</b> 4547315822829 -<br/> <b>6.50 KD, 80.00 SAR/AED, 75.00 QR, 8.50 BD/OMR</b><br/>                     The brush is made of plant-derived polyester fiber which is not prone to curl and gives a soft touch to the skin. The small size is convenient for the portability.</p>                                                                                                                                                                            | <p><b>2-Foundation Brush</b><br/>                     4547315822904 / 136 mm -<br/> <b>6.50 KD, 80.00 SAR/AED , 75.00 QR, 8.50 BD/OMR</b><br/>                     The brush is made of plant-derived polyester fiber, which is supple and can apply liquid foundation evenly. How to use: take appropriate amount of liquid foundation on the back of the hand, use the brush to blend on the skin evenly.</p> | <p><b>3-Eye Colour Brush</b><br/>                     4547315822812 / 126 mm –<br/> <b>3.50 KD, 45.00 SAR/AED, 40.00 QR, 5.00 BD/OMR</b><br/>                     The brush is made of plant-derived polyester fiber which gives a soft touch to the skin.<br/>                     How to use: take appropriate amount of liquid foundation on the back of the hand, use the brush to blend on the skin evenly.</p> |
| <p><b>4-Face Brush</b><br/> <b>105 ml-</b> 4549337385870 –<br/> <b>8.00 KD, 100.00 SAR/AED/QR, 10.00 BD/OMR</b><br/> <b>146 ml-</b> 4547315822805 –<br/> <b>8.00 KD, 100.00 SAR/AED/QR, 10.00 BD/OMR</b><br/> <b>168 ml-</b> 4547315822836 -<br/> <b>7.00 KD, 100 SAR/AED/QR, 9.00 BD/OMR</b><br/>                     The brush is made of plant-derived polyester fiber which is not prone to curl and gives a soft touch to the skin. The trimmed flat with a volume is the ideal shape for face brush. How to use: Use the brush to take out appropriate amount of cheek colour, adjust the colour on the tissue paper first before applying on the face to create a natural makeup.</p> | <p><b>5-Eye Shadow Brush</b><br/>                     4550002868024 –<br/> <b>1.25 KD, 15.00 SAR/AED/QR, 1.50 BD/OMR</b><br/>                     Can be stored in the makeup palette.</p>                                                                                                                                                                                                                      | <p><b>6-Lip Brush For Case</b><br/>                     4550002868048 –<br/> <b>1.00 KD, 10.00 SAR/AED/QR, 1.25 BD/OMR</b></p>                                                                                                                                                                                                                                                                                       |
| <p><b>7-Cheek Brush For Case</b><br/>                     4550002868086 –<br/> <b>1.25 KD, 15.00 SA/AED/QR, 1.50 BD/OMR</b></p>                                                                                                                                                                                                                                                                                                                                                                                                                                                                                                                                                              | <p><b>8-Loose Powder Brush</b><br/>                     4550002868093 –<br/> <b>1.75 KD, 20.00 SAR/AED/QR, 2.00 BD/OMR</b><br/>                     Can be stored in the makeup palette.</p>                                                                                                                                                                                                                    | <p><b>11- Eye Brow Brush</b><br/>                     4550002868031 –<br/> <b>1.25 KD, 15.00 SAR/AED/QR, 1.50 BD/OMR</b></p>                                                                                                                                                                                                                                                                                         |
| <p><b>9-Aluminium Polyester Lip Brush</b><br/>                     4549337385863-<br/> <b>2.25 KD, 30.00 SAR/AED/QR, 3.00 BD/OMR</b><br/>                     The brush is made of plant-derived polyester fiber which is not prone to curl and gives soft touch to the skin. It is supple and can be used to blend on the lips evenly. It can be stored easily and conveniently.</p>                                                                                                                                                                                                                                                                                                        | <p><b>10-Aluminium Polyester Lip Brush</b><br/>                     4549337385856 –<br/> <b>3.00 KD, 35 SAR/AED, 30.00 QR, 3.50 BD/OMR</b><br/>                     The brush is made of plant-derived polyester fiber which is not prone to curl and gives soft touch to the skin. It is supple and can be used to blend on the lips evenly. It can be stored easily and conveniently.</p>                     |                                                                                                                                                                                                                                                                                                                                                                                                                      |

### Makeup Application:



- |                                                                                                                                                                                                                                                                                                                                                                                                                                             |                                                                                                                                                                                                                                                                                           |                                                                                                                                                                                                                                                                                                                                                                                                  |
|---------------------------------------------------------------------------------------------------------------------------------------------------------------------------------------------------------------------------------------------------------------------------------------------------------------------------------------------------------------------------------------------------------------------------------------------|-------------------------------------------------------------------------------------------------------------------------------------------------------------------------------------------------------------------------------------------------------------------------------------------|--------------------------------------------------------------------------------------------------------------------------------------------------------------------------------------------------------------------------------------------------------------------------------------------------------------------------------------------------------------------------------------------------|
| <p><b>1-Eyebrow Brush Comb</b><br/>                     4547315822843 –<br/> <b>3.00 KD/BD/OMR, 35.00 SAR/AED, 30.00 QR</b></p>                                                                                                                                                                                                                                                                                                             | <p><b>2-Eye Colour Tip</b><br/>                     4547315822867 –<br/> <b>3.00 KD/BD/OMR, 35.00 SAR/AED, 30.00 QR</b></p>                                                                                                                                                               | <p><b>3-Makeup Sponge</b><br/>                     4550002547578 / 40 pcs –<br/> <b>3.00 KD, 35.00 SAR/AED/QR, 4.00 BD/OMR</b><br/>                     The shape of this sponge makes it easy to finish makeup around the eyes and the wings of the nose.</p>                                                                                                                                   |
| <p><b>4-Sponge Puff</b><br/>                     4549738756439 / 4 pcs –<br/> <b>3.00 KD, 35.00 SAR/AED, 30.00 QR, 2.50 BD/OMR</b><br/>                     The sponge puff has adequate flexibility and is easy to use. It fits the skin well for even finish of makeup. The size fits into the MUJI ABS Foundation Case. When it gets dirt, use a sponge cleaner or neutral detergent to wash, rinse thoroughly and then hang to dry.</p> | <p><b>5-Sponge Puff For Liquid Foundation</b><br/>                     4549738756415-<br/> <b>3.00 KD, 35.00 SAR/AED, 30.00 QR, 2.50 BD/OMR</b><br/>                     The liquid does not soak easily into the puff, so the liquid foundation can be applied easily without waste.</p> | <p><b>6-Soft Sponge Puff</b><br/>                     4549738756422 –<br/> <b>1.75 KD, 25.00 SAR/AED, 20.00 QR, 2.00 BD/OMR</b><br/>                     The fluffy and smooth sponge contains natural moisturising component. The size fits into the MUJI ABS Foundation Case. When it gets dirty, use a sponge cleaner or neutral detergent to wash, rinse thoroughly and then hang to dry</p> |
|                                                                                                                                                                                                                                                                                                                                                                                                                                             | <p><b>8- Eye Colour Tip</b><br/>                     4550002868055 –<br/> <b>1.00 KD, 10.00 SAR/AED/QR, 1.25 BD/OMR</b></p>                                                                                                                                                               | <p><b>9-Eye Colour Tip &amp; Brush</b><br/>                     4550002868062 / 2 pcs -<br/> <b>1.75 KD, 20.00 SAR/AED/QR, 2.00 BD/OMR</b></p>                                                                                                                                                                                                                                                   |
|                                                                                                                                                                                                                                                                                                                                                                                                                                             |                                                                                                                                                                                                                                                                                           | <p><b>10- Eyelash Curler</b><br/> <b>58 mm-</b> 4547315844449 –<br/> <b>3.00 KD/BD/OMR, 35.00 SAR/AED, 30.00 QR</b><br/> <b>104 mm-</b> 4547315844388 –<br/> <b>3.00 KD/BD/OMR, 35.00 SAR/AED, 30.00 QR</b></p>                                                                                                                                                                                  |

## Cut Cotton & Cotton Buds



### 1-Cut Cotton Ecru

4549337318885 / 180 seet 60x50 mm  
Made with long, unbleached fibers which make them incredibly soft. Versatile cut cotton type.

2.00 KD, 25.00 SAR/AED,  
20.00 QR, 2.50 BD/OMR

### 2-Cut Cotton

4549337318908 / 165 seet 65x50 mm  
Made with long, unbleached fibers which make them incredibly soft. Versatile cut cotton type.

1.50 KD, 20.00 SAR/AED,  
15.00 QR, 2.00 BD/OMR

### 3-Cut Cotton Ecru/L

4549337318892 / 135 seet 90x70mm  
Large Cotton pads made from soft, unbleached cotton. These are made in Japan and made from 100% cotton.

2.50 KD, 35.00 SAR/AED,  
30.00 QR, 3.00 BD/OMR

### 4-Peelable Cotton

4549738743415 / 85x60mm  
Individually, these cotton pads can be split into four sheets. This makes them ideal for economic use or for use as a facemask, after having applied your product. Cotton 100%, 162 Sheets.

3.00 KD, 40.00 SAR/AED,  
35.00 QR, 4.00 BD/OMR

### 5-Cotton Puff

4549337318915 / 189 sheets 60x50mm

1.25 KD, 15.00 SAR/AED,  
12.00 QR, 1.50 BD/OMR

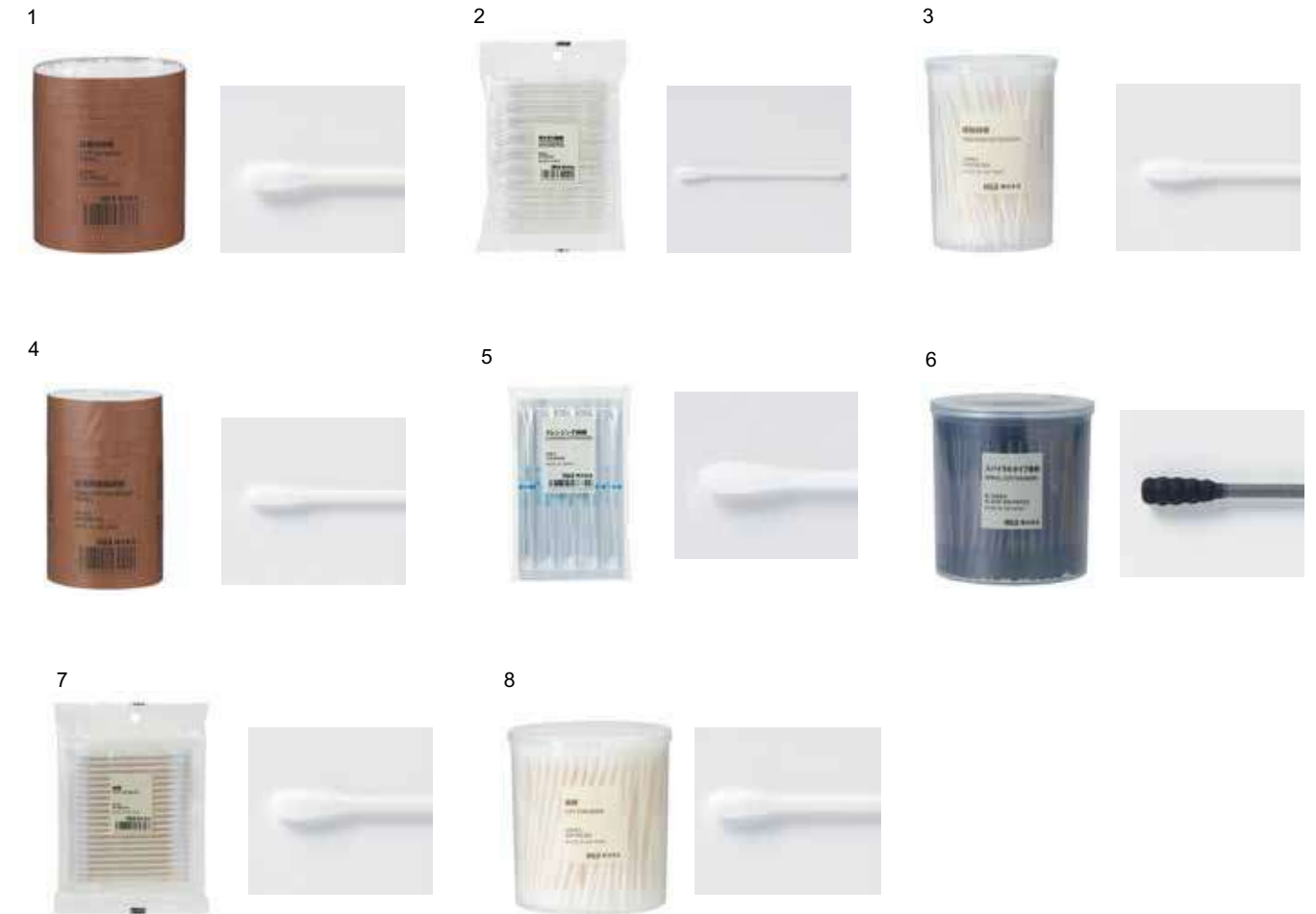

### 1-Cotton Buds Refill

4547315570386 / 200 pcs  
Cotton buds with 100% cotton tips and paper shafts. Sanitary due to chitosan antibacterial processing.

0.75 KD, 10.00 SAR/AED, 7.00 QR, 1.00 BD/OMR

### 2-Cotton Swab W/Ear Pick

4945247320992 / 50 pcs  
Cotton buds with ear pick on one side. Made with a supple paper shaft. Individually wrapped, making them sanitary and easily portable.

1.00 KD/BD/OMR 12.00 SAR/AED, 10.00 QR,

### 3-Thin Cotton Bud

4547315570362 / 200 pcs  
Made of 100% cotton, the cotton bud has a supple and ultra-thin paper shaft. It is sanitary due to chitosan antibacterial processing.

1.50 KD, 20.00 AED/SAR/QR, 2.00 BD/OMR

### 4-Thin Cotton Buds Refill

4547315570409 / 200 pcs  
Cotton buds with 100% cotton tips and paper shafts. Sanitary due to chitosan antibacterial processing. These thin type cotton buds are convenient for babies or for cleaning small places.

1.25 KD, 15.00 AED/SAR/QR,  
1.50 BD/OMR

### 5-Cleansing Cotton Buds

4547315276899 / 10 pcs  
The cotton bud is made of 100% cotton. The tip part contains cleanser, which can be used conveniently for touching up partial makeup. It is of individual package which is hygienic and portable.

1.50 KD, 20.00 AED/SAR,  
15.00 QR, 1.50 BD/OMR

### 6-Cotton Buds

4934761396705  
The black cotton bud shows up dirt clearly. It is sanitary due to chitosan antibacterial processing.

1.25 KD, 15.00 AED/SAR/QR,  
1.50 BD/OMR

### 7-Cotton Buds

4547315570393 / 80 pcs  
The cotton bud is made with 100% cotton and supple paper shaft. It is sanitary due to chitosan antibacterial processing.

0.60 KD, 10.00 AED/SAR,  
7.00 QR, 0.75 BD/OMR

### 8-Cotton Buds

4547315570379 / 200 pcs  
(SMALL ITEM) Made with 100% cotton, these cotton buds have a supple paper shaft. Sanitary due to chitosan antibacterial processing.

1.25 KD, 15.00 AED/SAR,  
10.00 QR, 1.50 BD/OMR

## Nylon Makeup Boxes

Nylon Makeup Boxes are compatible with PP Makeup Boxes, allowing easy assembly for a customised storage unit. The lid is specifically designed for storing makeup brushes, minimising the chance of cross-contamination. Small tools and items such as sewing accessories or first-aid kit tools can be stored in the boxes for easy transport.



**Makeup Box L**

4550002546403  
15.00 KD, 200.00 SAR/AED/QR,  
15.00 BD/OMR  
Grey



**Makeup Box M**

4550002546397  
12.00 KD, 150.00 SAR/AED/QR,  
12.00 BD/OMR  
Grey



**Makeup Box S**

4550002546380  
9.00 KD, 125.00 SAR/AED/QR,  
9.5 BD/OMR  
Grey



**Makeup Box L**

4550002546373  
15.00 KD, 200.00 SAR/AED/QR,  
15.00 BD/OMR  
Black



**Makeup Box M**

4550002547561  
12.00 KD, 150.00 SAR/AED/QR,  
12.00 BD/OMR  
Black



**Makeup Box S**

4550002547554  
9.00 KD, 125.00 SAR/AED/QR,  
9.5 BD/OMR  
Black



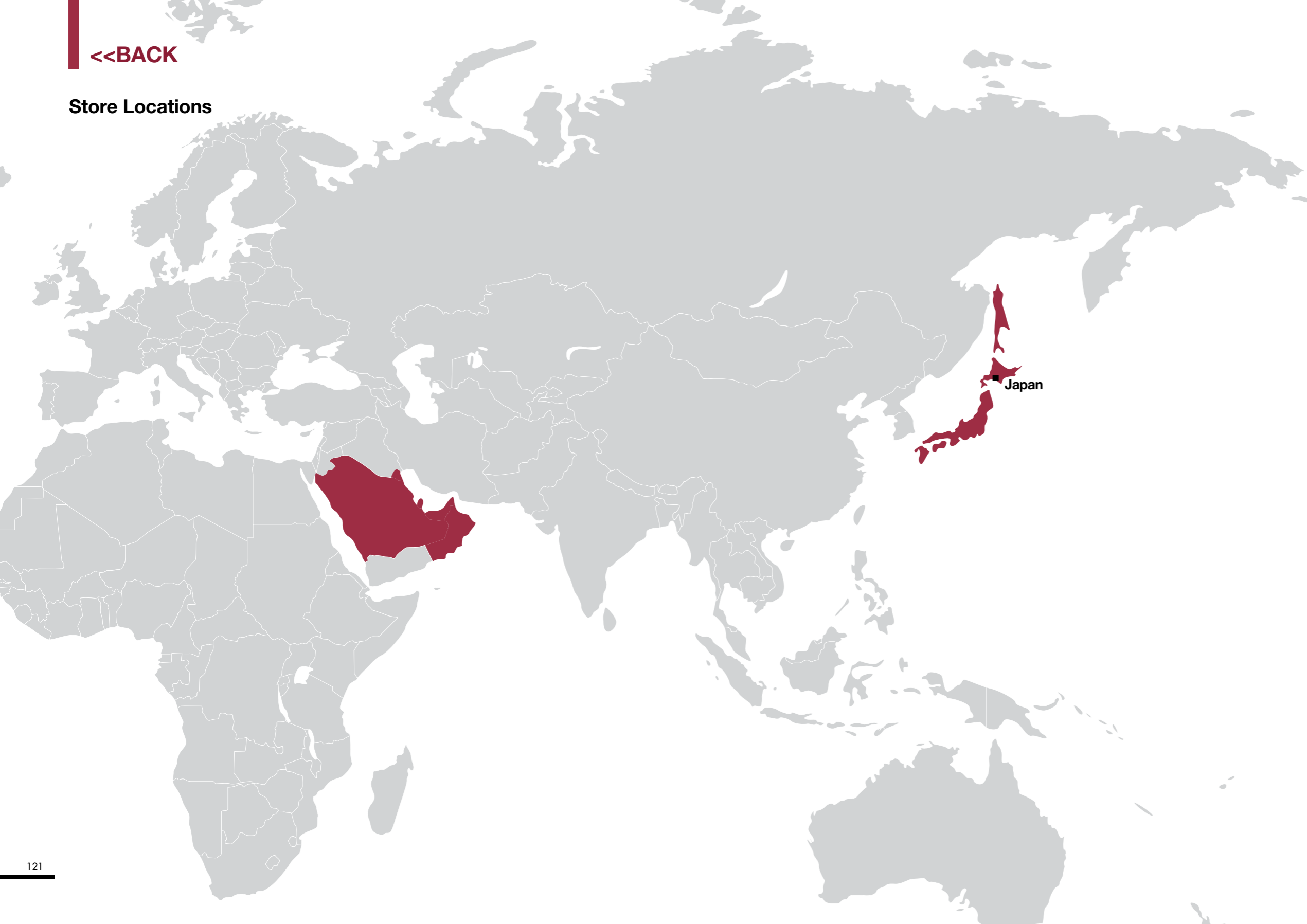

Over 800 stores around the world

1. UAE:

Dubai:

The Dubai Mall: (+971) 4 419 0205 / 06 / 07  
City Centre Mirdif: (+971) 4 419 0670 / 69 / 68  
The Beach, opposite JBR: (+971) 4 419 0868 / 69  
Mall of the Emirates (Debenham's Concession): (+971) 4 419 0472

Abu Dhabi:

Yas Mall: (+971) 2 492 6555 / 56 / 57  
Al Wahda Mall : (+971) 2 695 8230 / 40  
The Galleria, Al Maryah Island : (+971) 2 492 6790 / 91  
Jimi Mall: (+971) 3 701 8110 / 11

2. KSA

Red Sea Mall: (+966) 12 261 7474 / 79  
Hayat Mall: (+966) 11 510 1237 / 38  
Riyadh Gallery: (+966) 11 510 1491 / 90  
Riyadh Park: (+966) 11 520 3564 / 65  
Alrashid Mall: (+966) 13 667 8719

3. Kuwait

Grand Avenue - The Avenues: (+965) 2 228 3147 / 48  
2nd Avenue - The Avenues, First Floor: (+965) 2 228 3797 / 98  
Al Kout Mall: (+965) 2 208 1149 / 34

4. Qatar

Doha Festival City: (+974) 4 452 1463 / 64  
Villaggio: (+974) 4 452 9059/60

5. Bahrain

City Centre Bahrain: (+973) 1 711 0385 / 86  
The Avenues - Bahrain: (+973) 1 711 0561 / 62

6. Oman

Mall of Muscat: (+968) 22303560 / 61





-The selection of goods available may vary between individual stores.

-Size specifications represent gross external measurements and are for guidance only.

-If the size margin of a product is critical to your chosen function we recommend that you obtain accurate measurements instore.

-Please note that colours may vary slightly between catalogue image and actual product. Whilst every effort is made to ensure that all products featured are in constant supply, we apologise if any item is occasionally out of stock due to customer demand. Some items are seasonal and may only be stocked for short periods of time.

# MUJI online ecommerce

Coming soon.....

<https://www.alshaya.com/en/brands/fashion-footwear/muji/>

<http://www.muji.com/ae-en>